

PRODUCTION of SPUN WHEELS - F LINE

RIM PRODUCTION

WHEEL COMPLETING

OPTIONS

Machine No:

EF1
Guillotine

Machine Type:

Cutting strip from steel sheet

EF2
Rolling Machine

Rolling cylinder

F1
SAF Plasma Welder

Welding cylinder

F2
Hydraulic Press

Coning cylinder

F3
MTV Spinning machine

Cold forming - spinning

F4
Hump roller

Forming hump & horn

F5
Hydraulic Press

Punching valve hole

PRODUCED DISCS

PLASMA CUT - flat
LASER CUT - flat & formed

EF4
Welding table

Track disc welding

EF3
Hydraulic Press

Pressing disc into rim

F6
Welder with turn table

Complete welding

EF4
Welding table

Valve guard welding

EF4
Welding table

Tack welding of reinforcement ring

F6
Welder with turn table

Welding reinforcement

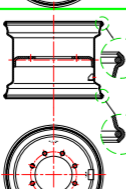
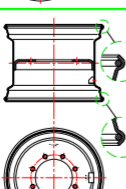
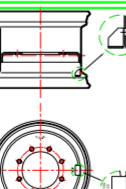
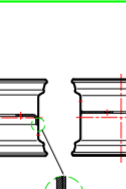
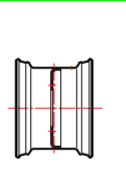
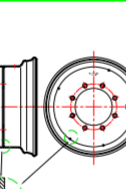
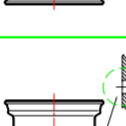
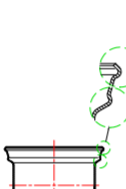
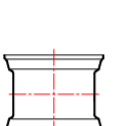
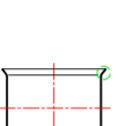
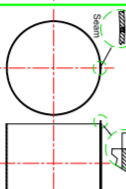
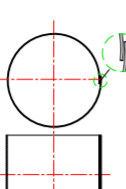

LEGEND:

Wt - THEORETICAL CAPACITY

Wg - ACTUAL CAPACITY